

Products 2026

Repair Kits & Parts for Common-Rail Injectors
for the 4.5L,6.8L,8.1L,9.0L John-Deere Diesel
Engine Platforms



The best solution to repair your
diesel injection systems, with perfectly
interchangeable spare parts.

The best solution to repair your diesel injection systems, with perfectly interchangeable spare parts.

This catalogue introduces our products for Repair Kits & Parts for Common-Rail Injectors for the 4.5L,6.8L,8.1L,9.0L John-Deere Diesel Engine Platforms

System HPCR (High Pressure Common-Rail)



Scan here to
download
this catalog

If you need additional technical information,
please contact our support team:

Email: info@stardiesel.com

Call: +39 (051) 63 25404

Visit: www.stardiesel.com

CODE REFERENCES

Spare parts which make part of "STAR" exclusive, though they are not genuine they are interchangeable with genuine ones. Manufacturer's reference numbers have only an indicative purpose. Any reference to genuine brand is purely practical and for referral use only. DTM Ricambi does not own any property on these trademarks, nor does any other company controlled by DTM RICAMBI.

Catalogue Contents

Engine 4.5L/6.8L - 4045T,6068T.....	Page 4
Engine 8.1L 6081HT.....	Page 12
Engine 9.0L 6090HT.....	Page 14

CODE REFERENCES

Spare parts which make part of "STAR" exclusive, though they are not genuine they are interchangeable with genuine ones. Manufacturer's reference numbers have only an indicative purpose. Any reference to genuine brand is purely practical and for referral use only. DTM Ricambi does not own any property on these trademarks, nor does any other company controlled by DTM RICAMBI.

John Deere Repair Kits & Engine 4.5L/6.8L - 4 Cylinders

Suitable On Engine: John-Deere 4045T 4.5D year 2005- John-Deere 6068T 6.8D year 2005

Repair Kit Injector



STAR Code: **60.166/83**

Reference OEM:

Injector

Injector reference:

RE516540, RE519730, RE507860, SE501924, 095000-5050, 095000-5051, RE546781, RE524382, RE529118, SE501926, 095000-6490, 095000-6491, 095000-6492, 095000-8800, 095000-8801, RE546782, RE529414, RE529117, SE501927, 095000-6500, 095000-6501, 095000-8720, 095000-8721, RE534111, RE533505, SE501933, 095000-7150, 095000-7151

Image of Spare Parts Installation on the Injector



Tube connector
RE522594



Spare Parts Identification

Nr.1	30916/52	OEM: R505452
Nr.2	31089/20	OEM: R65397
Nr.3	52327	OEM: R515535
Nr.4	59136/05	OEM: /

Any use of images or information from this document without prior approval from STAR diesel is prohibited.

John Deere Repair Kits & Engine 4.5L/6.8L - 4 Cylinders

Suitable On Engine: John-Deere 4045T 4.5D year 2005- John-Deere 6068T 6.8D year 2005

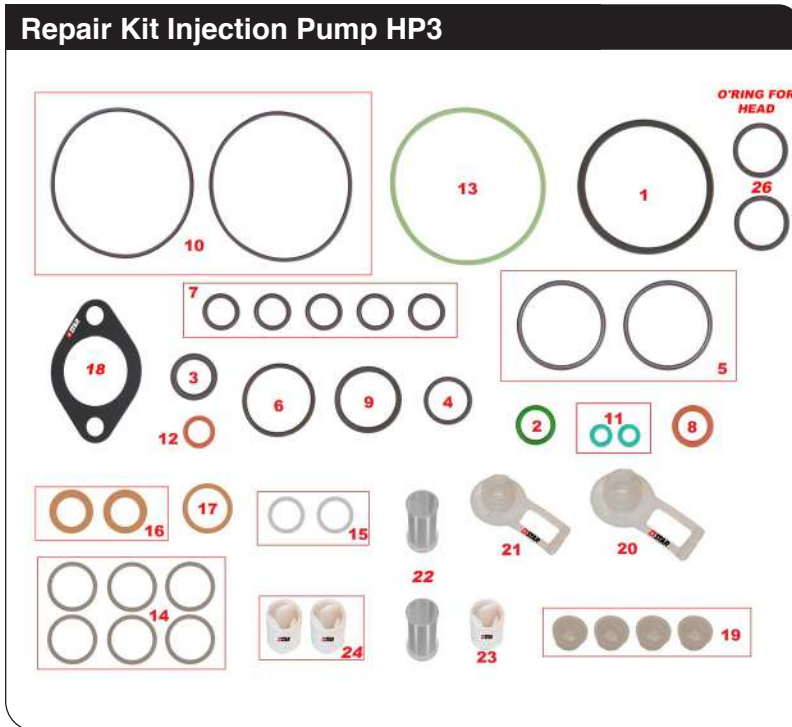

STAR Code: 60.166

Reference OEM: 294009-0030,
294009-0031,294009-0032

Injection Pump

Injection Pump reference:
RE507959, RE527528, SE501916,
SE501915

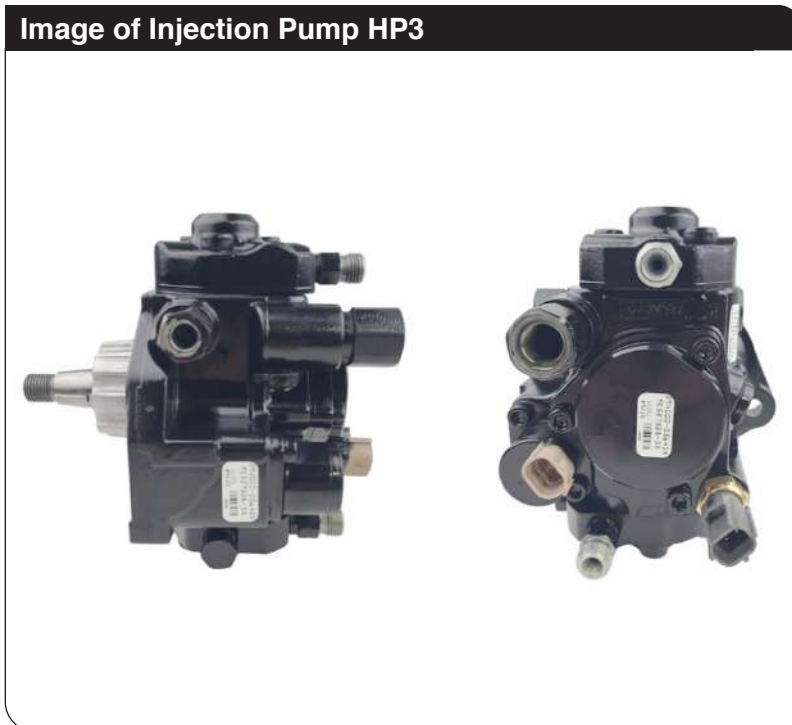

STAR Code: 90.811
Pressure Control Valve

Pressure Control Valve reference:
RE560091



Any use of images or information from this document without prior approval from STAR diesel is prohibited.

John Deere Repair Kits & Engine 4.5L/6.8L - 4 Cylinders

Suitable On Engine: John-Deere 4045T 4.5D year 2005- John-Deere 6068T 6.8D year 2005

Repair Kit Injector

PLEASE NOTE THEY WILL BE DELIVERED UNFOLDED



STAR Code: **60.166/84**

Reference OEM:

Injector

Injector reference:

RE546784, RE531209, RE530362, SE501925, 095000-6310, 095000-6311, RE546783, RE531210, RE530361, SE501928, 095000-6320, 095000-6321

Image of Spare Parts Installation on the Injector



Spare Parts Identification

Nr.1	52243	OEM: R522899
Nr.2	59134/12	OEM: /
Nr.3	30914/05	OEM: R516647
Nr.4	52339	OEM: R523499
Nr.5	59136/05	OEM: /

Any use of images or information from this document without prior approval from STAR diesel is prohibited.

John Deere Repair Kits & Engine 4.5L/6.8L - 4 Cylinders

Suitable On Engine: John-Deere 4045T 4.5D year 2005- John-Deere 6068T 6.8D year 2005

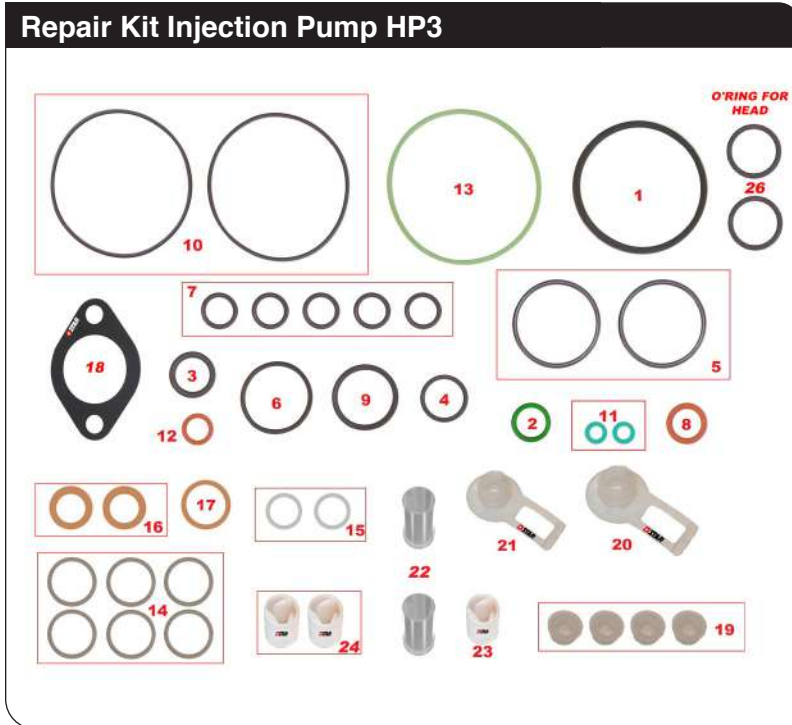

STAR Code: 60.166

Reference OEM: 294009-0030,
294009-0031,294009-0032

Injection Pump

Injection Pump reference:
RE507959, RE527528, SE501916,
SE501915

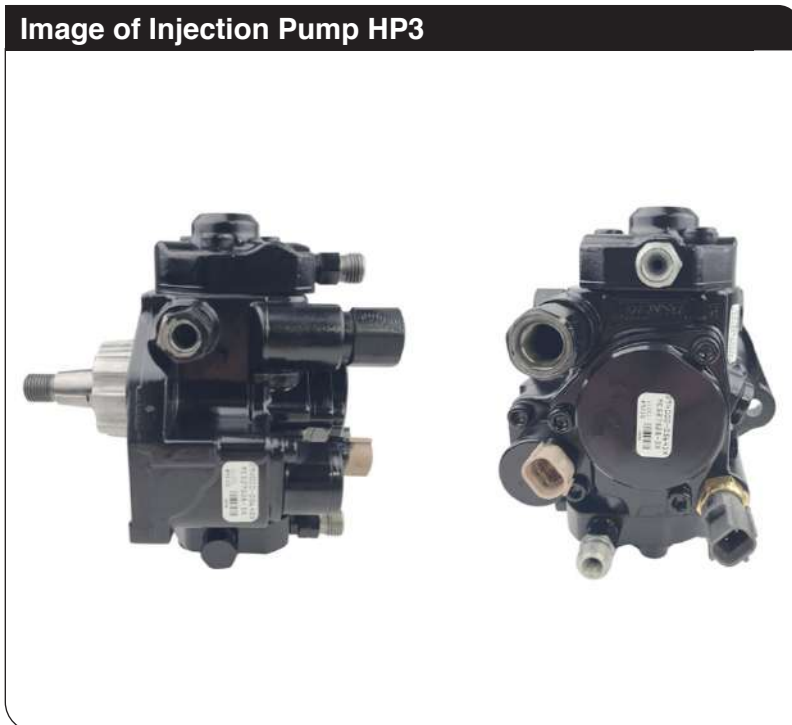

STAR Code: 90.811 Pressure Control Valve

Pressure Control Valve reference:
RE560091



Any use of images or information from this document without prior approval from STAR diesel is prohibited.

John Deere Repair Kits & Engine 4.5L/6.8L - 4 Cylinders

Suitable On Engine: John-Deere 4045T 4.5D year 2005- John-Deere 6068T 6.8D year 2005

Repair Kit Injector



STAR Code: **60.166/85**

Reference OEM:

Injector

Injector reference:

RE546780, RE533454, RE532216, SE501934, 095000-6880, 095000-6881, 095000-8810

Image of Spare Parts Installation on the Injector

STAR
Diesel Injection Parts

Tube connector
RE522594



Spare Parts Identification

Nr.1	31916/52	OEM: R505452
Nr.2	31089/20	OEM: R65397
Nr.3	52381	OEM: R131051
Nr.4	59136/05	OEM: /

Any use of images or information from this document without prior approval from STAR diesel is prohibited.

John Deere Repair Kits & Engine 4.5L/6.8L - 4 Cylinders

Suitable On Engine: John-Deere 4045T 4.5D year 2005- John-Deere 6068T 6.8D year 2005

Repair Kit Injection Pump HP3

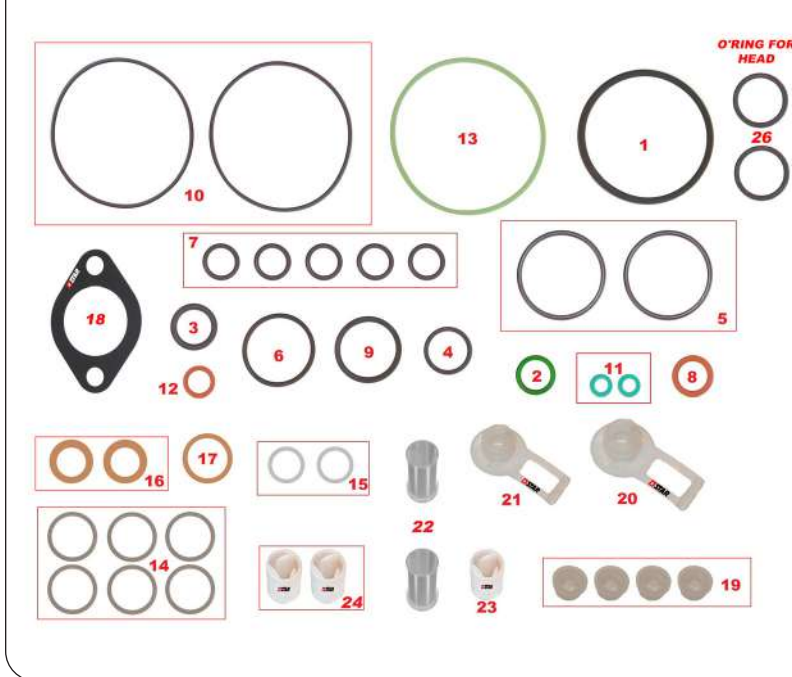

STAR Code: 60.166

Reference OEM: 294009-0030,
294009-0031,294009-0032

Injection Pump

Injection Pump reference:
RE507959, RE527528, SE501916,
SE501915

Image of Injection Pump HP3



STAR Code: 90.811
Pressure Control Valve

Pressure Control Valve reference:
RE560091



Any use of images or information from this document without prior approval from STAR diesel is prohibited.

John Deere Repair Kits & Engine 4.5L/6.8L - 4 Cylinders

Suitable On Engine: John-Deere 4045T 4.5D year 2005- John-Deere 6068T 6.8D year 2005

Repair Kit Injector



STAR Code: **60.166/86**

Reference OEM:

Injector

Injector reference:
RE545562, RE543351, SE502671,
095000-0590

Image of Spare Parts Installation on the Injector



Spare Parts Identification

Nr.1	31916/52	OEM: R505452
Nr.2	30995/07	OEM: R63548
Nr.3	30916/54	OEM: R74354
Nr.3	52381	OEM: R131051
Nr.4	59136/05	OEM: /

Any use of images or information from this document without prior approval from STAR diesel is prohibited.

John Deere Repair Kits & Engine 4.5L/6.8L - 4 Cylinders

Suitable On Engine: John-Deere 4045T 4.5D year 2005- John-Deere 6068T 6.8D year 2005

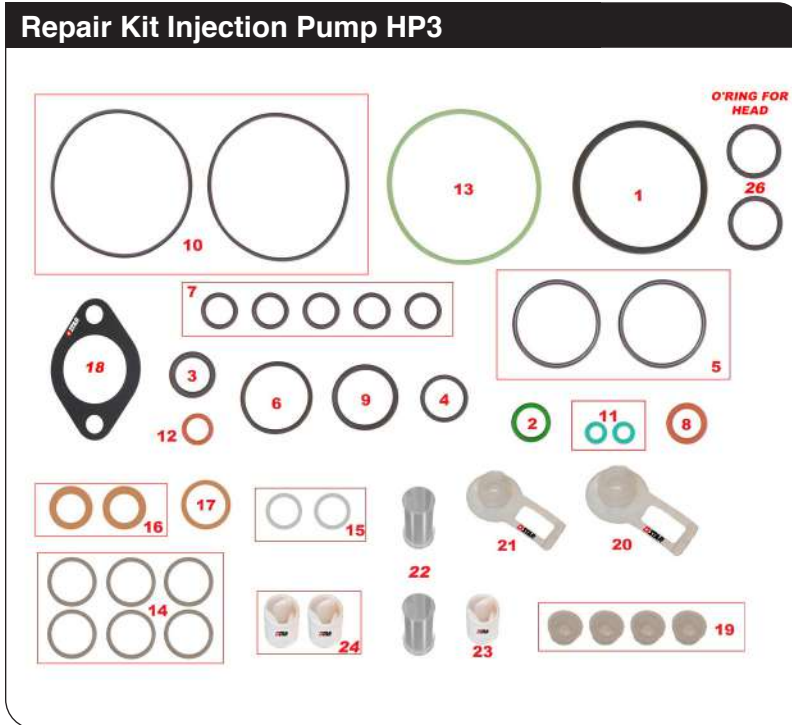

STAR Code: 60.166

Reference OEM: 294009-0030, 294009-0031, 294009-0032

Injection Pump

Injection Pump reference:
RE507959, RE527528, SE501916, SE501915

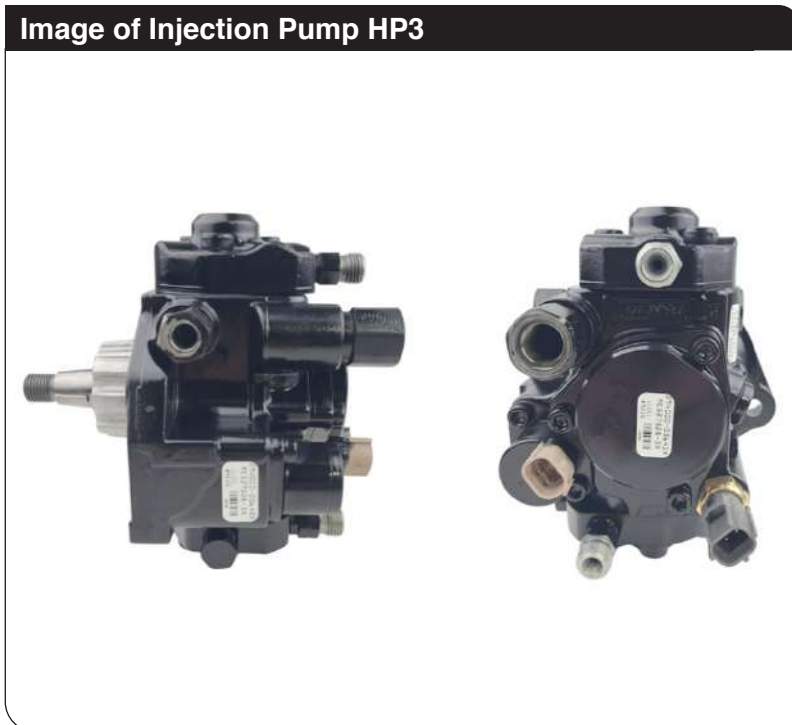

STAR Code: 90.811 Pressure Control Valve

Pressure Control Valve reference:
RE560091



Any use of images or information from this document without prior approval from STAR diesel is prohibited.

John Deere Repair Kits & Engine 8.1L - 6 Cylinders

Suitable On Engine: John-Deere 6081T 8.1D year 2003

Repair Kit Injector



STAR Code: **60.166/87**

Reference OEM:

Injector

Injector reference:

RE535961, RE518726, SE501936, 095000-5150, RE524368, RE501010, SE501940, RE524361, 095000-0550, 095000-0551, RE524360, SE501935, 095000-5230, RE524362, RE518725, RE504181, SE501937, 095000-5160, RE524369, SE501941, 095000-0540, 095000-0541, 095000-0542, 095000-0543, 095000-0544, 095000-0545, 095000-0546, 095000-0547, 095000-0548, 095000-0549, 970950-0547, RE524364, RE518723, SE501939, 095000-5190

Image of Spare Parts Installation on the Injector



Spare Parts Identification

Nr.1	30916/55	OEM: R503578
Nr.2	31704/05	OEM: R135526
Nr.3	52381	OEM: R131051
Nr.4	59136/05	OEM: /

Any use of images or information from this document without prior approval from STAR diesel is prohibited.

John Deere Repair Kits & Engine 8.1L - 6 Cylinders

Suitable On Engine: John-Deere 6081T 8.1D year 2003

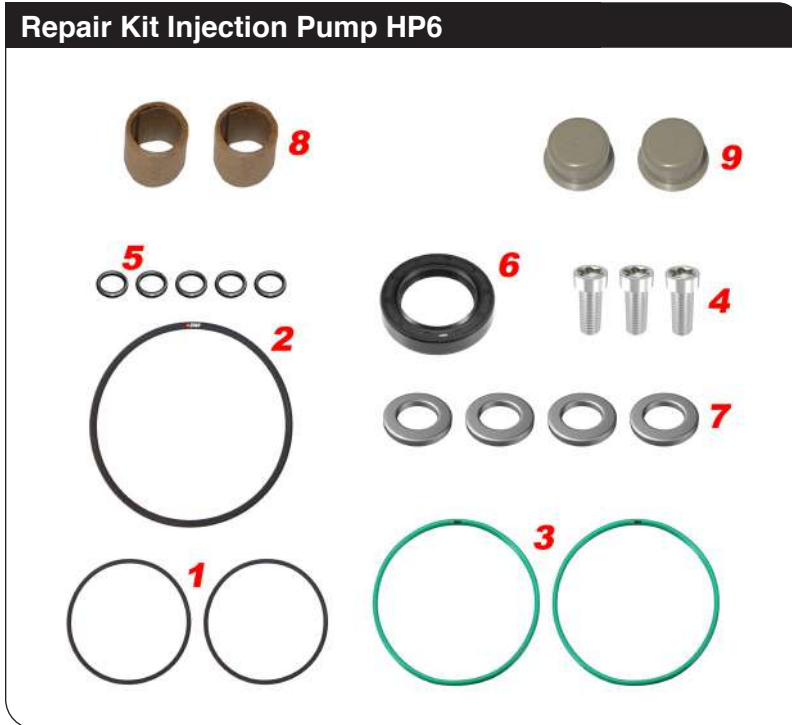

STAR Code: 60.166/18

Reference OEM:

Injection Pump

Injection Pump reference:
RE564861, RE549623, RE569911,
299050-0150, 299050-0020,
299050-0021, 299050-0151,
299050-0140, DZ128161, DZ123504

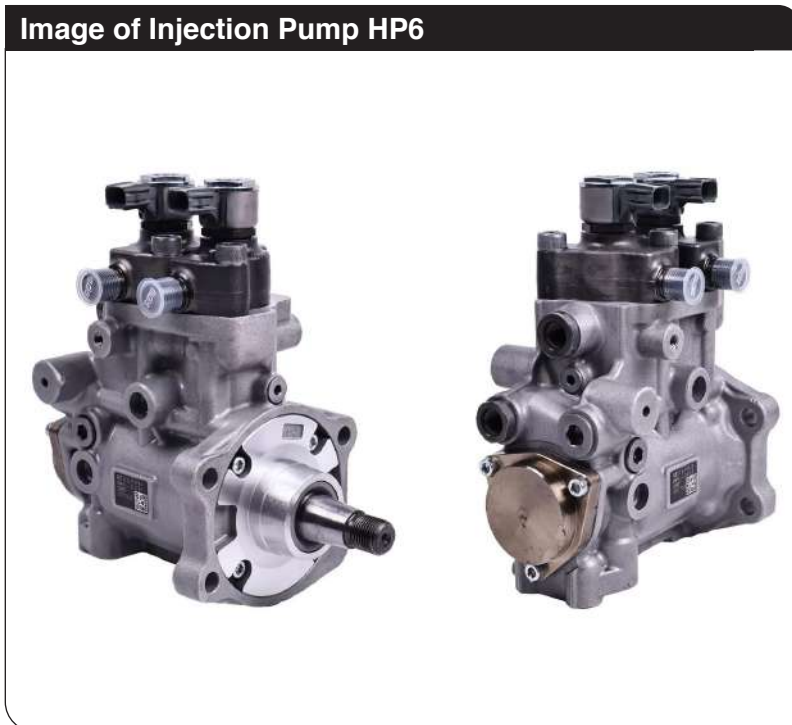

STAR Code: 49278/42
COVER FILTER

STAR
Diesel Injection Parts



• **Thread:**
14,00x1,50 mm

STAR
Diesel Injection Parts



• **Thread:**
1"-14 UNF

Any use of images or information from this document without prior approval from STAR diesel is prohibited.

John Deere Repair Kits & Engine 9.0L - 6 Cylinders

Suitable On Engine: John-Deere 6090HT year 2006

Repair Kit Injector



STAR Code: **60.166/86**

Reference OEM:

Injector

Injector reference:

RE543605, RE543352, RE543606,
RE543354, RE546776, RE528407,
RE529149, RE546777

Image of Spare Parts Installation on the Injector



Spare Parts Identification

Nr.1	30916/52	OEM: R505452
Nr.2	30995/07	OEM: R63548
Nr.3	30916/54	OEM: R74354
Nr.4	52381	OEM: R131051
Nr.5	59136/05	OEM: /

Any use of images or information from this document without prior approval from STAR diesel is prohibited.

John Deere Repair Kits & Engine 9.0L - 6 Cylinders

Suitable On Engine: John-Deere 6090HT year 2006

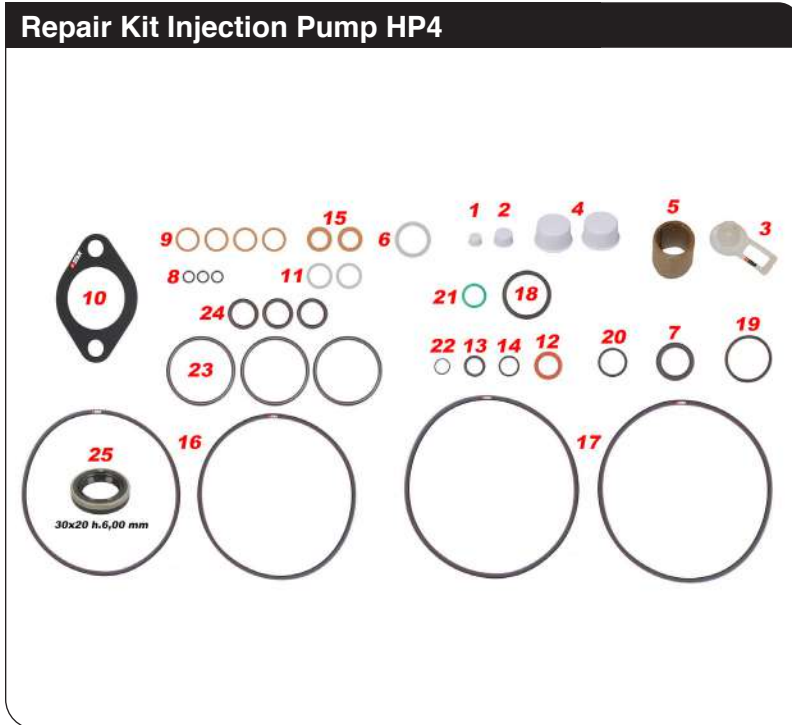

STAR Code: 60.166/04

Reference OEM: 294009-0050,
294050-0520

Injection Pump

Injection Pump reference:
RE519597, RE534156, RE546126,
RE571640, RE534165

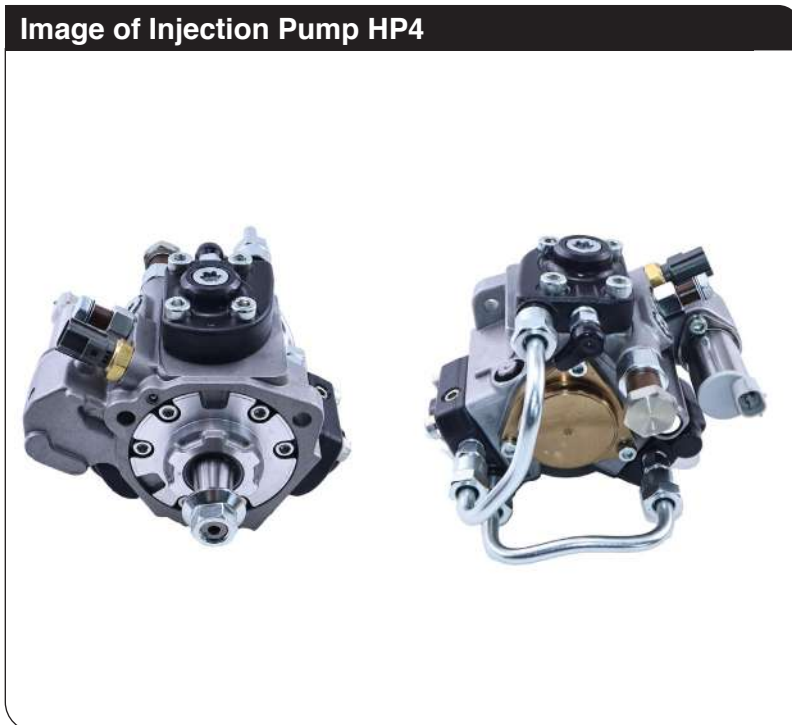

STAR Code: 90.825 Pressure Control Valve

Pressure Control Valve reference:
RE536508, RE572088



Any use of images or information from this document without prior approval from STAR diesel is prohibited.



If you need additional technical information,
please contact our support team:

Email: info@stardiesel.com

Call **+39 (051) 63 25404**

Visit www.stardiesel.com

Thousand of spare parts for 64 countries

*It took us two generations to reach every
corner of the world from the heart of the
Motor Valley.*

Since the early 1980s, we have pursued an international
vision that led us to build a large network of partners.

Today, the main share of our market is international.
Spare part retailers, distributors, and diesel centres
worldwide can rely on our brand.



The STAR diesel logo is the property of D.T.M. Ricambi srl
Logistics and operational headquarters:
Via della Cooperazione nr.5 - 40129 Bologna ITALY
Telephone +39 (051) 63 25404 E-mail: info@stardiesel.com
Internet: www.stardiesel.com